

## DISPOSABLE ELECTRONIC FLEXIBLE CYSTO/URETEROSCOPE SYSTEM

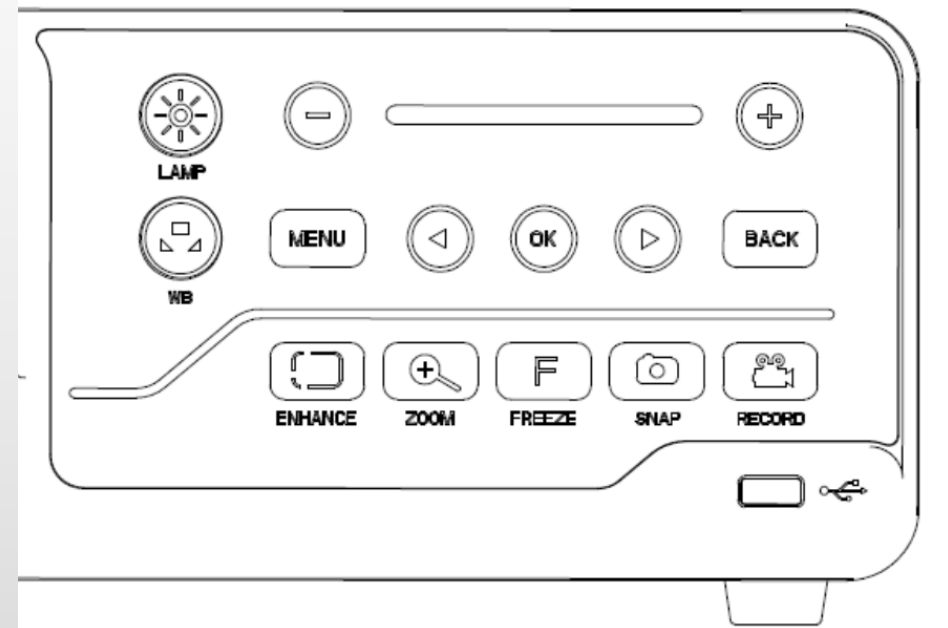

No.	Name	Description
1.	Power switch	Power supply for image processing system.
2.	Light guide connection socket	Connect a disposable endoscopic light guide plug for lighting and image transmission
3.	LAMP	Use this button to turn the lamp on or off.
4.	Luminance control -	Reduce brightness
5.	LED luminance indicator bar	Indicate the current brightness level
6.	Luminance control +	Increase brightness
7.	WB	Use this button to adjust the white balance.
8.	MENU	Opens the [Setup] tab.
9.	ENHANCE	Switches the enhancement level.
10.	ZOOM	Switches the digital zoom level.
11.	FREEZE	Switches between the freeze mode and video mode.
12.	SNAP	Captures and outputs a still image in a USB flash memory.
13.	RECORD	Recording and save video to USB flash memory.
14.	USB	This connector is for connecting a USB flash memory

## FRONT PANEL

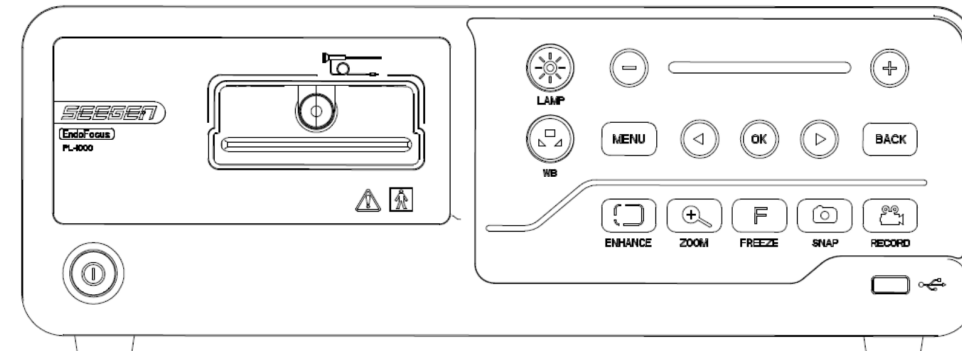

## BACK PANEL

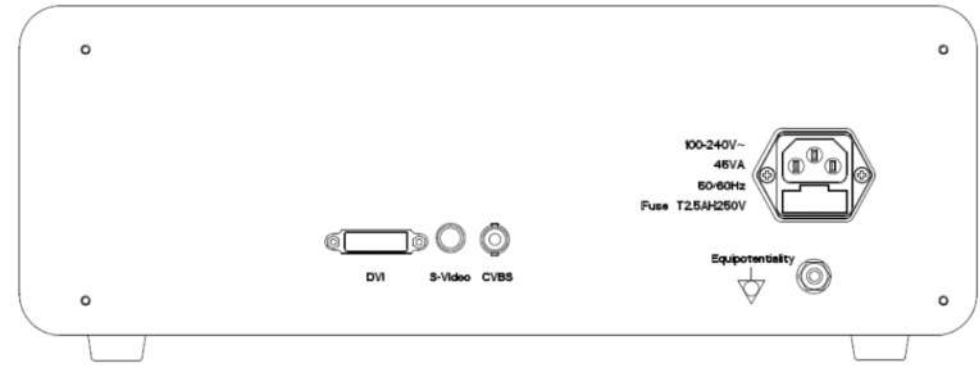

No.	Name	Description
1.	DVI	These connectors are for outputting video signals [DVI signals (digital)] to a monitor or image processor.
2.	S-Video	This connector (separated video outputs) is for outputting separate video signals (video signals separated into light signals and color signals) to a monitor, printer, or image processor.
3.	CVBS video	
4.	Power Input Socket	Connect the power cord.
5.	Fuse Box	The fuse box contains two fuses.
6.	Potential Equalization Terminal	This terminal is used with a condenser earth cable to equalize the potential of other equipment connected to the processor.

